

Skyline Room

Perched on the Museum’s topmost floor just beneath the 230-foot spire, the Skyline Room offers panoramic views of the Charles River, Back Bay, Boston, and Cambridge through two walls of floor-to-ceiling windows. By day, natural light floods the space while birds wing by at eye level. By night, the sparkling mosaic of city lights provides a dramatic backdrop for any evening event. Sunsets are spectacular!

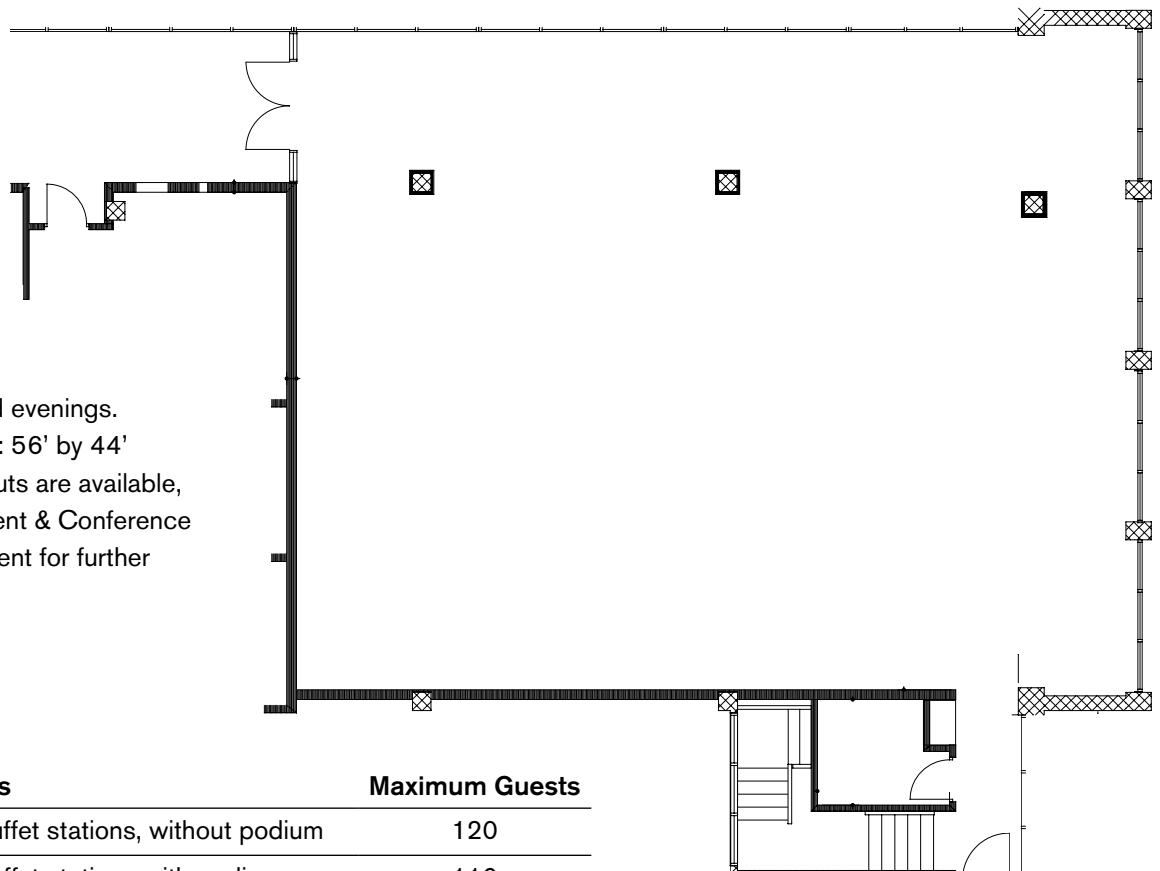

Availability

Available days and evenings.
 Room dimensions: 56' by 44'
 Various room layouts are available, please call the Event & Conference Services Department for further information

Capacity

Function Options	Maximum Guests
Plated meal or buffet stations, without podium	120
Plated meal or buffet stations with podium	110
Plated meal with dancing	100
Buffet stations, full seating with dancing	80
Reception with limited seating (one-third)	150
Classroom style (8' tables only)	70
Theatre style	120
U-shape	28-32
Hollow Square	40